

AMENITIES

- ◇ 1 & 2 Bedroom Floor Plans
- ◇ Designed for Seniors and Persons with Disabilities
- ◇ Energy Efficient Appliances, HVAC & Windows
- ◇ Washer/Dryer Hook Ups in Units
- ◇ Ceiling Fans
- ◇ Private Patio & Outdoor Storage
- ◇ Energy Efficient Construction
- ◇ All-Electric Utilities
- ◇ Gazebo, Garden, Picnic Area & Grill
- ◇ Walking Trail
- ◇ Large Community Building with Beauty Salon
- ◇ On-Site Leasing Office
- ◇ On-Site Laundry
- ◇ Many Services Offered
- ◇ Peaceful Location

Professionally
managed by:



DIRECTIONS

LOCATED ON N. COLFAX STREET
APPROX. 1.0 MILE EAST OF DOWNTOWN WARSAW
OR
APPROX. 1.0 MILE WEST OF US 30

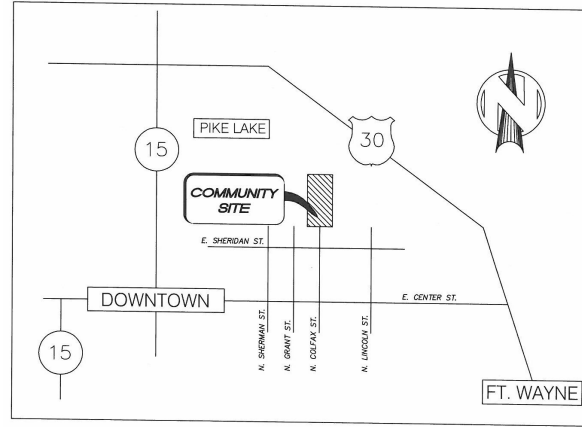

PROPERTY LOCATION MAP

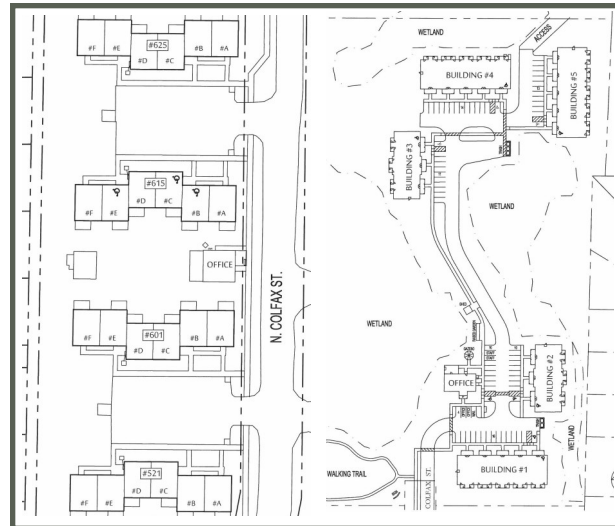

675 N. Colfax Street
Warsaw, IN 46580

(574) 267-0111



Corporate Office
P.O. Box 40518
Indianapolis, IN 46240



This institution is an equal opportunity provider and employer.

WELCOME HOME TO WILLOW PARK!!

WHAT "AFFORDABLE" MEANS

Willow Park at Beyer Farm offers one and two bedroom apartments to match your lifestyle and will provide you with all the modern conveniences you desire...
at an affordable rent level.

As providers of affordable housing, we must lease our apartments to households meeting income guidelines set by the federal government.

Income maximums are determined annually and are based on the number of persons living in your household. The combined gross household income cannot exceed specific ranges:

- SEE SITE MANAGER FOR MORE INFORMATION

FEES & DEPOSIT

Non-refundable application fee	\$25.00
Move-in security deposit	See Manager

A NEW CHOICE

Spread out in the spacious living spaces, cook with reliable appliances and sleep well knowing it's all within your budget! Never thought you'd get the chance to move into a quality apartment? Think again.

Willow Park at Beyer Farm is Warsaw's finest choice in affordable housing, with units now available. Traditional single-story buildings feature spacious floor plans, private entries, and plenty of extra storage space for all the little things that make a house a home.

We believe that you should be able to live affordably without sacrificing your standard of living. Whether you are looking for more space, a peaceful place to settle down, or just a high-quality, affordable apartment,

Willow Park will fit your needs.

Call us today for more information about the next place you'll call home!

(574) 267-0111

FLOOR PLANS

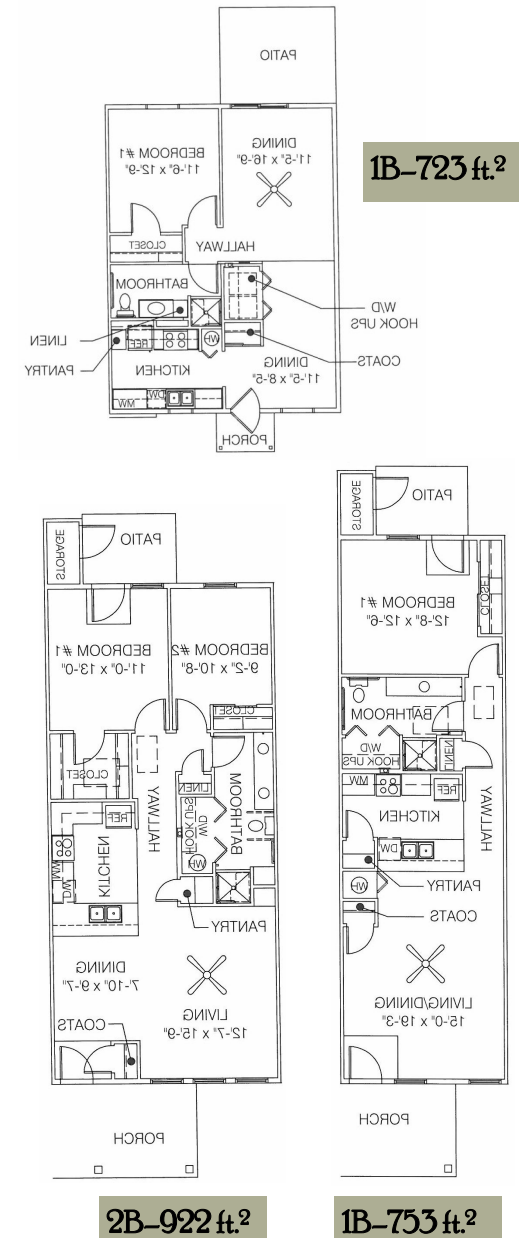

2B-922 ft.²

1B-753 ft.²